

**Viti Monobloc - Duo - Terrific Ref.**

Vite di fissaggio	per scanalature	
M 10 x 35	12 e 14 mm	06-080
M 10 x 40	16 e 18 mm	06-085
M 10 x 45	20 e 22 mm	06-090
Vite di fissaggio	per maschiature	
M 12 x 40	M 12	06-065
M 14 x 45	M 14	06-070
M 16 x 45	M 16	06-075

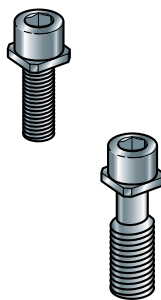

**Importante**  
Usare sempre le viti speciali KOPAL

**Fissaggio per Bloc Bride Ref.**

Tasselli speciali, vite TF e molla scanalatura	
12 mm	05-200
14 mm	05-205
16 mm	05-210
18 mm	05-215
20 mm	05-220
22 mm	05-225

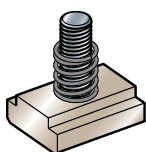

**Fissaggio per Piccolo Ref.**

M 8 x 30 mm	07-720
M 10 x 35 mm	07-730
M 12 x 35 mm	07-735

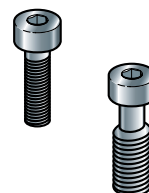

**Fissaggio per Maxibloc Ref.**

M 14 x 40 mm	06-720
M 16 x 44 mm	06-721
M 16 x 60 mm	06-723

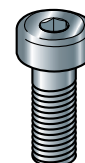

**Fissaggio per Big Block Ref.**

**Perno a tamburo**

fissaggio del Big Block sul tavolo

V2-C1 M 14 x 62 mm	08-060
V2-C1 M 14 x 82 mm	08-070
V2-C2 M 16 x 70 mm	08-080
V2-C2 M 16 x 80 mm	08-090

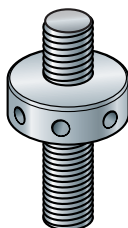

**Perni**

Fissaggio della base sul tavolo

V2-1 M 14 x 60 mm	08-100
V2-1 M 14 x 80 mm	08-110
V2-2 M 16 x 65 mm	08-120
V2-2 M 16 x 85 mm	08-130

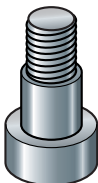

**Adattatore**

Fissaggio del Big Block sui blocchi di sollevamento e sulla base

Adattatore	08-140
------------	--------

**Tasselli per scanalature a T**

Scanalatura	M 8 Ref.	M 10 Ref.	M 12 Ref.	M 14 Ref.	M 16 Ref.
10 mm	90-050				
12 mm	90-055	90-100			
14 mm	90-060	90-105	90-150		
16 mm	90-065	90-110	90-155	90-200	
18 mm	90-070	90-115	90-160	90-205	90-250
20 mm		90-120	90-165	90-210	90-255
22 mm		90-125	90-170	90-215	90-260
24 mm		90-130	90-175	90-220	90-265
28 mm		90-135	90-180	90-225	90-270

